



MVS
Light

www.mvslight.com

sales@mvslight.com





MVS Light is one of the leading companies in the design and production of reliable and powerful lighting equipment warning lights, Siren and Speakers, Controllers and High-Powered warning systems for Emergency vehicles since 2006.

Our commitment to providing innovative products, devotion to delivering superior service and technical expertise comprise a unique position in the market.

MVS Light has been dedicated to serving customers globally with excellent-quality emergency vehicle warning solutions and control systems. Our comprehensive manufacturing approach and flexibility in designing to meet customers' inquiries assure our leadership in the market.

Each and every part of MVS Light product is proudly designed, manufactured and tested under harshest environments to meet the industry's outstanding certification requirements.

Our global reach capacity and commitment to safety and security are the motives that drive our innovative spirit. The experience of our product design teams, engineers, customer and technical support staff establishes our company as a trusted partner around the world.

A Type LED Light Bar





www.mvslight.com

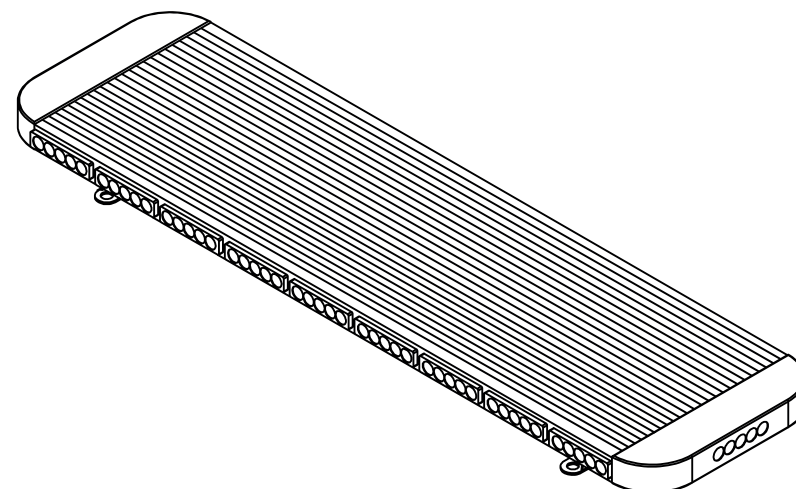
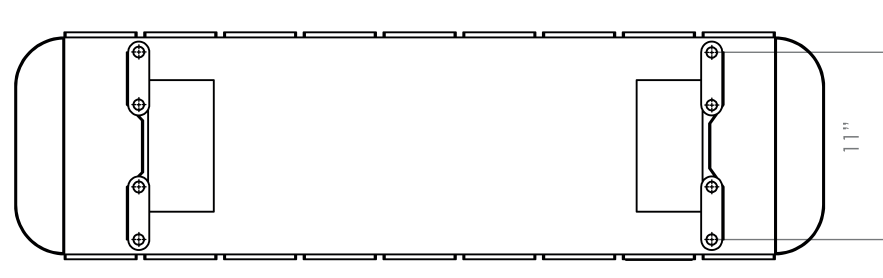
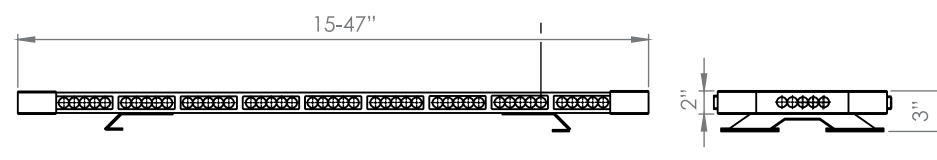
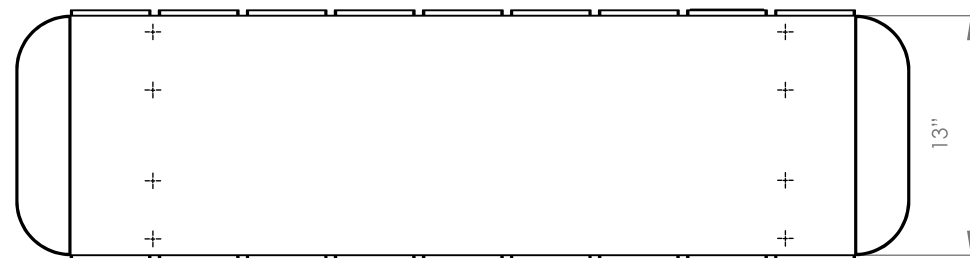

TECHNICAL SPECIFICATIONS

Product	A - TYPE	Available Sizes	15"-19"-24"-29"-33"-37"-38"-47"
Operating Voltage	9-30 VDC	Available Colors	White, Red, Blue, Amber, Green
LED	3 WATT POWER LED	Mounting	Fixed
LED Life Time	100.000 Hours	Cable	3.5 M Blue (Mode), Red (+), Black(-)
Flasing Mode	7	Standards	ECE R65, ECE R10, SAE J
Flashing Sequence	2-4 Hz	Quality System	CE, ISO 9001

- Transparent polycarbonate outer and inner lens provides clear signal light transmission.
- Stainless steel materials, including mounting and connection parts.
- Aluminum cover and base
- Strong mechanical strength, heat, and UV light resistance.
- Excellent protection against vibration, dust, moisture and high temperature.
- Available in customized color arrangements: White /Red/Blue/Amber/Green.
- Lead-free solder and electronic component used in compliance with European standards.
- LED Light Bars manufactured compliance with EMC/EMI standards.
- Ready to be customized to meet your special requirements.
- IP65 Protection

D Type LED Light Bar



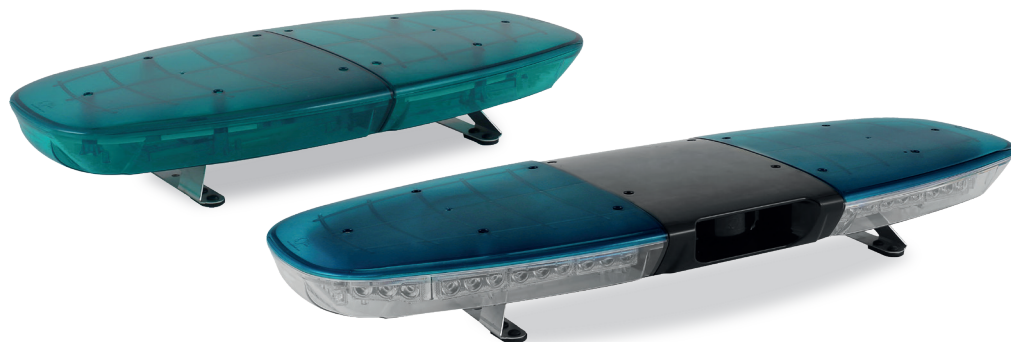

TECHNICAL SPECIFICATIONS

Product	D - TYPE	Available Sizes	20"-40"-47"-57"-63"
Operating Voltage	9-30 VDC	Available Colors	White, Red, Blue, Amber, Green
LED	3 WATT POWER LED	Mounting	Fixed
LED Life Time	100,000 Hours	Cable	3.5 M Blue (Mode), Red (+), Black(-)
Flashing Mode	7	Standards	ECE R65, ECE R10, SAE J
Flashing Sequence	2-4 Hz	Quality System	CE, ISO 9001

- Transparent polycarbonate outer and inner lens provides clear signal light transmission.
- Stainless steel materials, including mounting and connection parts.
- Aluminum cover and base
- Strong mechanical strength, heat, and UV light resistance.
- Excellent protection against vibration, dust, moisture and high temperature.
- Available in customized color arrangements: White /Red/Blue/Amber/Green.
- Lead-free solder and electronic component used in compliance with European standards.
- LED Light Bars manufactured compliance with EMC/EMI standards.
- Ready to be customized to meet your special requirements.
- IP65 Protection

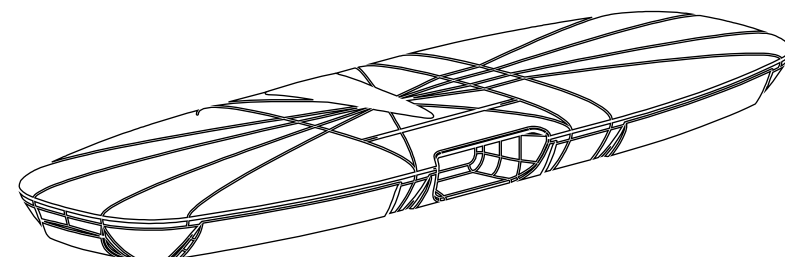
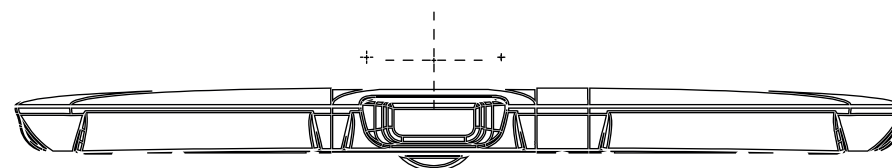
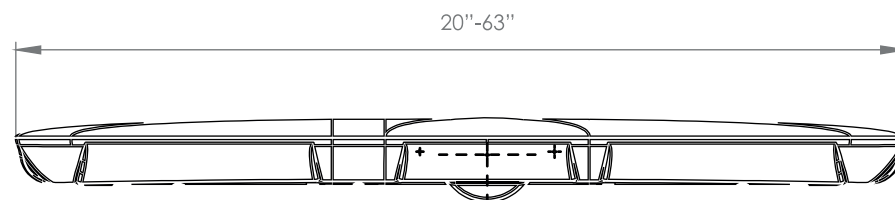
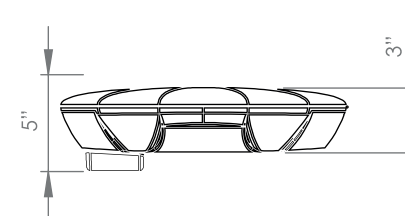
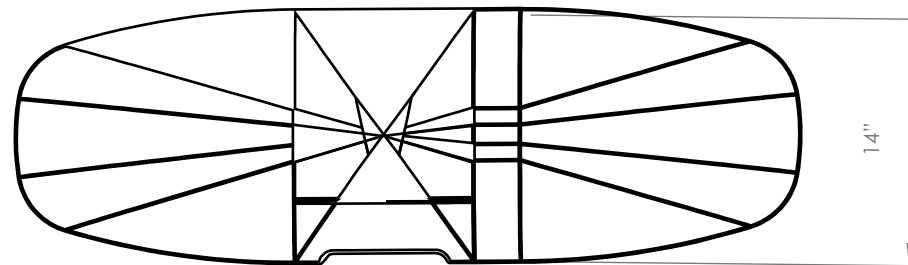

C Type LED Light Bar





TECHNICAL SPECIFICATIONS

Product	C - Type	Available Sizes	20"-40"-47"-57"-63"
Operating Voltage	9-30 VDC	Available Colors	White, Red, Blue, Amber, Green
LED	3 WATT POWER LED	Mounting	Fixed
LED Life Time	100,000 Hours	Cable	3.5 M Blue (Mode), Red (+), Black(-)
Flasing Mode	7	Standards	ECE R65, ECE R10, SAE J
Flashing Sequence	2-4 Hz	Quality System	CE, ISO 9001

- Transparent polycarbonate outer and inner lens provides clear signal light transmission.
- Strong mechanical strength, heat, and UV light resistance.
- Excellent protection against vibration, dust, moisture and high temperature.
- Available in customized color arrangements: White /Red/Blue/Amber/Green.
- Lead-free solder and electronic component used in compliance with European standards.
- LED Light Bars manufactured compliance with EMC/EMI standards.
- Ready to be customized to meet your special requirements.
- IP65 Protection

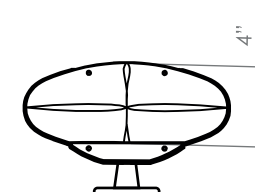
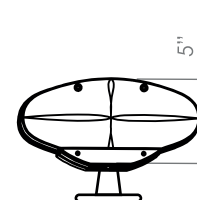
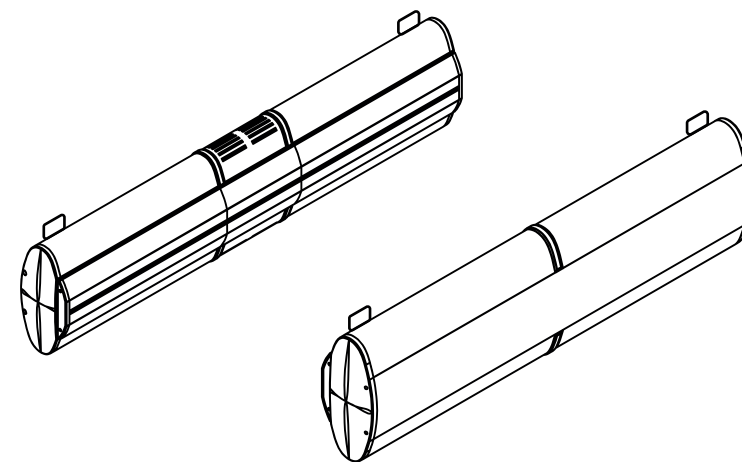
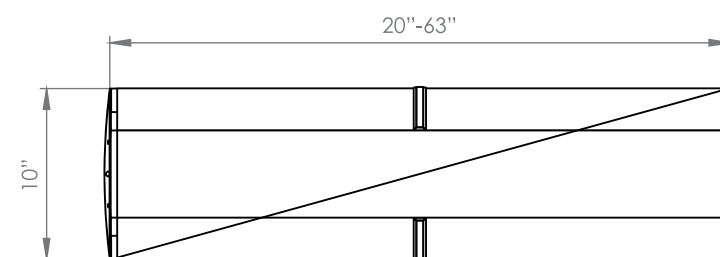
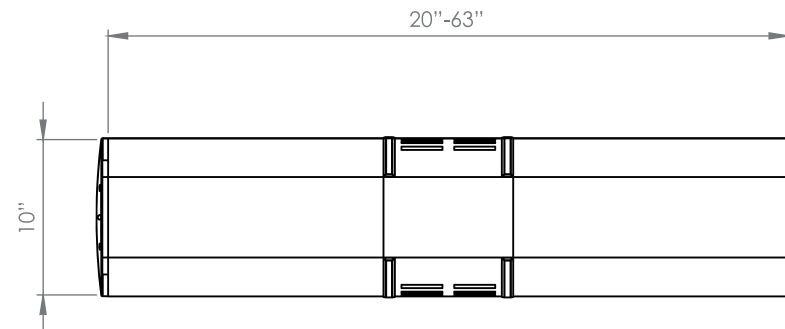

E Type LED Light Bar



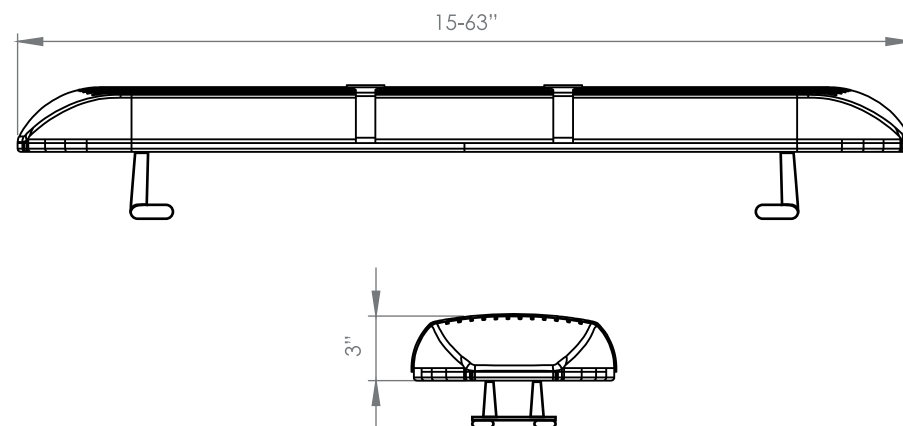

TECHNICAL SPECIFICATIONS

Product	E - TYPE	Available Sizes	15"-31"-35"-41"-50"-57"-63"
Operating Voltage	9-30 VDC	Available Colors	White, Red, Blue, Amber, Green
LED	3 WATT POWER LED	Mounting	Fixed
LED Life Time	100.000 Hours	Cable	3.5 M Blue (Mode), Red (+), Black(-)
Flasing Mode	7	Standards	ECE R65, ECE R10, SAE J
Flashing Sequence	2-4 Hz	Quality System	CE, ISO 9001

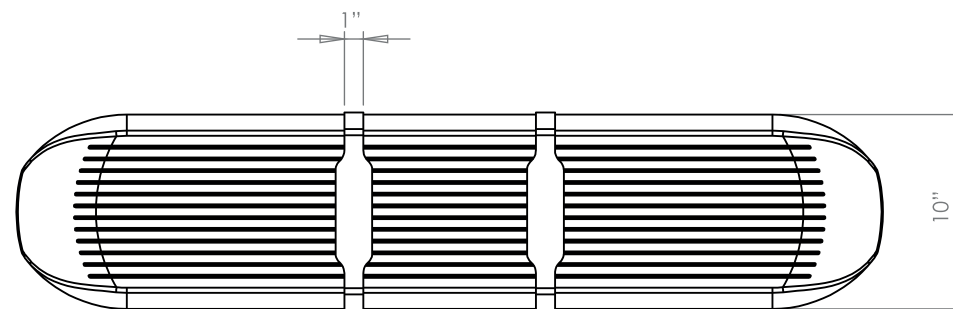

- Transparent polycarbonate outer and inner lens provides clear signal light transmission.
- Strong mechanical strength, heat, and UV light resistance.
- Hard-coated lenses and durable housing minimize environmental damage.
- Excellent protection against vibration, dust, moisture and high temperature.
- Available in customized color arrangements: White /Red/Blue/Amber/Green.
- Lead-free solder and electronic component used in compliance with European standards.
- LED Light Bars manufactured compliance with EMC/EMI standards.
- Ready to be customized to meet your special requirements.
- IP65 Protection

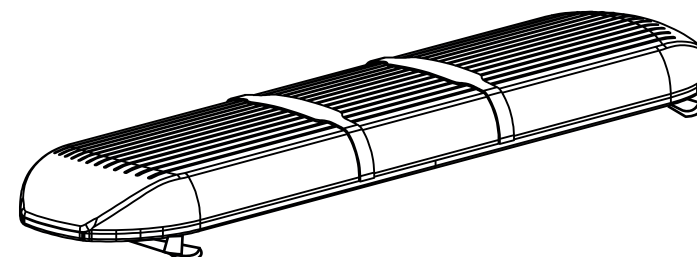

T Type LED Light Bar





www.mvslight.com



TECHNICAL SPECIFICATIONS

Product	T - TYPE	Available Sizes	17"-26"-31"-35"-44"47"-54"-63"
Operating Voltage	9-30 VDC	Available Colors	White, Red, Blue, Amber, Green
LED	3 WATT POWER LED	Mounting	Fixed / Magnet
LED Life Time	100.000 Hours	Cable	3.5 M Blue (Mode), Red (+), Black(-)
Flasing Mode	7	Standards	ECE R65, ECE R10, SAE J
Flashing Sequence	2-4 Hz	Quality System	CE, ISO 9001

- Transparent polycarbonate outer and inner lens provides clear signal light transmission.
- Ready to be customized to meet your special requirements
- Strong mechanical strength, heat, and UV light resistance.
- Hard-coated lenses and durable housing minimize environmental damage.
- Excellent protection against vibration, dust, moisture and high temperature.
- Available in customized color arrangements: White /Red/Blue/Amber/Green
- Lead-free solder and electronic component used in compliance with European standards.
- LED Light Bars manufactured compliance with EMC/EMI standards.
- Ready to be customized to meet your special requirements.
- IP65 Protection

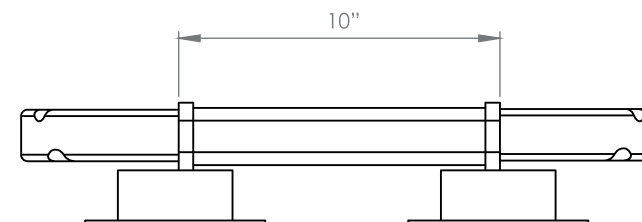
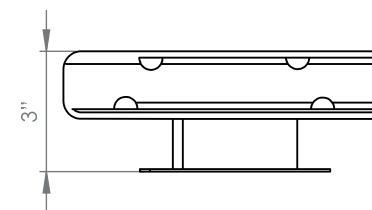

H Type LED Light Bar





TECHNICAL SPECIFICATIONS

- Product: H - Type
- Operating Voltage: 9 - 30 VDC, (Charged 12 VOLT DC)
- Easy installation with magnetic feet and suction cups
- 7 different flash patterns.
- Optional front / rear and Night / Day mode operation feature.
- 3 Watt High Power LED with no UV emitting
- Min. 8 hours of operation at battery mode,
- 5 hour charge duration by car cigarette lighter socket
- Remote control feature at battery mode
- 15 Degree ultra-strong integrated lens structure
- Aluminium Body with TS EN 573-3 / DIN 1725 Standards,
- 360-degree light distribution and ultra thin ergonomic Structure
- Protection against Vibration, Dust, Moisture, High Temperature
- Stainless installation and connection materials
- Dimensions: Length 24 cm-2 m, Width 9.6 cm, Height 4.5 cm (with feet)
- Short circuit and reverse connection protection
- Lead-free electronic component in accordance with European standards
- Standards: EMC/EMI, SAE J 845/578/1318, E37, TS EN 6247 / IEC 62471
- Quality System: CE, ISO 9001

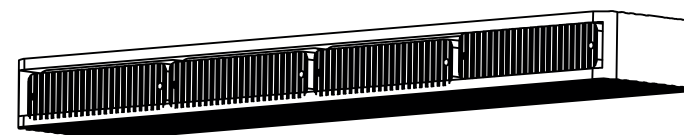
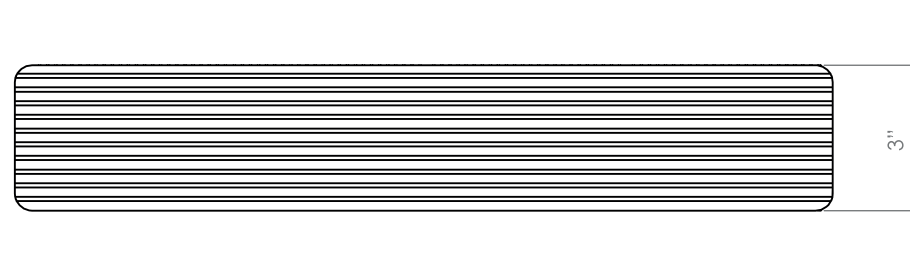
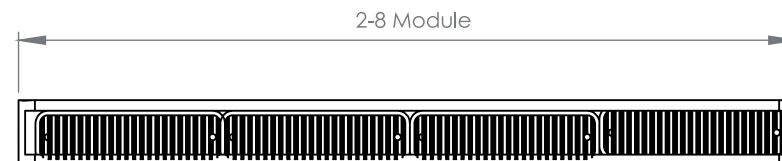
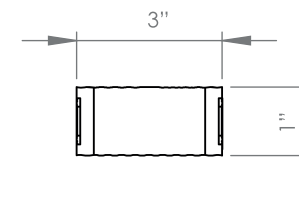
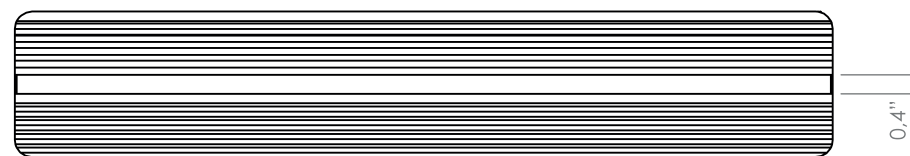

Digital Message Light Bar





TECHNICAL SPECIFICATIONS

Product	Digital Message Light Bar	Available Sizes	28"-47"
Operating Voltage	9-30 VDC	Available Text	Follow Me, Slow, Stop, Long Vehicle
LED	3 WATT POWER LED	Mounting	Fixed
LED Life Time	100.000 Hours	Cable	3.5 M Blue (Mode), Red (+), Black(-)
Flasing Mode	7	Standards	ECE R65, ECE R10, SAE J
Flashing Sequence	2-4 Hz	Quality System	CE, ISO 9001

- Transparent polycarbonate outer and inner lens provides clear signal light transmission.
- Stainless steel materials, including mounting and connection parts.
- Strong mechanical strength, heat, and UV light resistance.
- Excellent protection against vibration, dust, moisture and high temperature.
- Available in customized color arrangements: White /Red/Blue/Amber/Green.
- Lead-free solder and electronic component used in compliance with European standards.
- LED Light Bars manufactured compliance with EMC/EMI standards.
- Ready to be customized to meet your special requirements.
- IP65 Protection



Flashing Beacon Lights





sales@mvslight.com



TECHNICAL SPECIFICATIONS

- Operating Voltage: 9-30 VDC
- 12 x 3 Watt Power LED
- LED driver card with current and voltage control
- Ability to work in 6 different flashing modes
- Vacuum / magnet mounting
- Ability to operate with car lighter socket
- Dimensions: Standard length 16 cm, top R 11 cm, bottom R 15 cm
- Produced with IP 66 standards
- Vibration, dust, humidity and high temperature resistant structure
- Waterproof
- Operating Temperature: -30 ° C to +70 ° C
- Standards: ECE R65, ECE R10, SAE J
- Quality System: CE, ISO 900

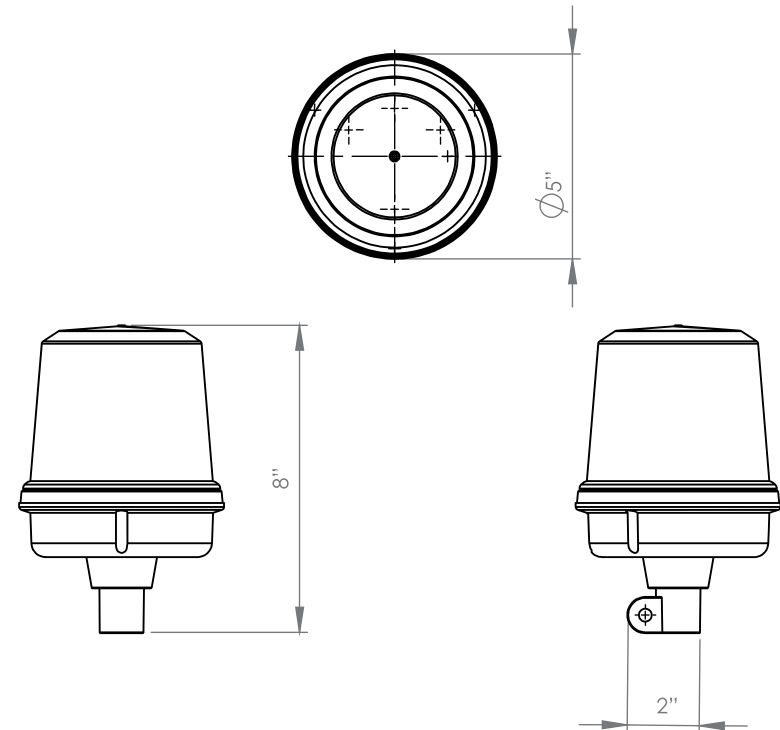
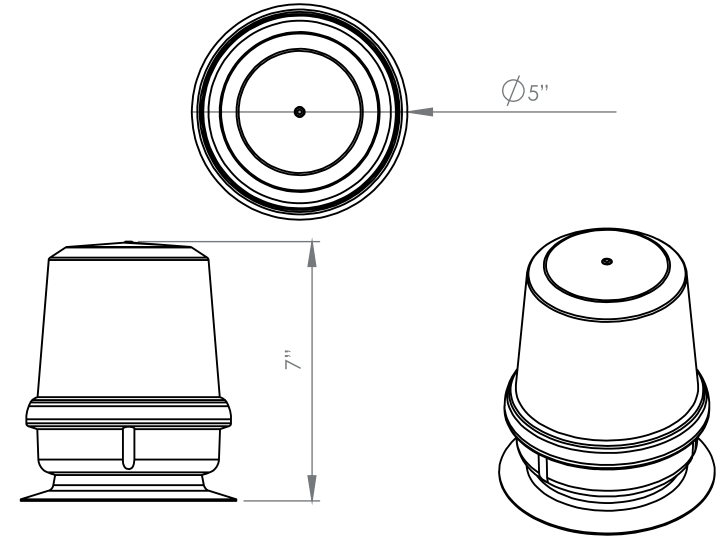

Exterior And Surface Mount Lightheads



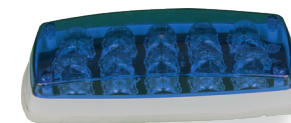
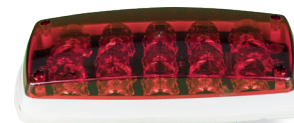
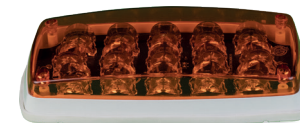

TECHNICAL SPECIFICATIONS

- Transparent polycarbonate outer and inner lens provides clear signal light transmission.
- Stainless steel materials, including mounting and connection parts.
- Strong mechanical strength, heat, and UV light resistance.
- Excellent protection against vibration, dust, moisture and high temperature.
- Available in customized color arrangements: White /Red/Blue/Amber/Green.
- Lead-free solder and electronic component used in compliance with European standards.
- LED Light Bars manufactured compliance with EMC/EMI standards.
- Ready to be customized to meet your special requirements.
- IP65 Protection

Product	Exterior and Surface Mount
Operating Voltage	9-30 VDC
LED	3 WATT POWER LED
LED Life Time	100.000 Hours
Mounting	Fixed
Standarts	ECE R65, ECE R10, SAE J
Quality System	CE, ISO 9001

Siren Speaker Systems



TECHNICAL SPECIFICATIONS

Operating Voltage: 12 VDC

(Output Power: 2x100 Watt (RMS), sound 2x50 Watt (Announcement)
Siren and announcement device totally controlled by microprocessor
Integrated cooling system for long time operations
LED warning system on the remote control for active functions
Animated LED indicator for the light flashing modes
Push & Talk button available on the remote control for announcement
meters spiral wired remote control

Remote Control Features

Two warning light buttons
Flashing pattern button
(External audio input button (AUX / RADIO)
Air horn button
Manual siren sound button
Wail sound button
Yelp sound button
Phaser sound button
Remote control holder
Remote Control Dimensions: 52 × 108 × 27 mm

Technical Features

Aluminum body
Dimensions: 110 × 50 × 180 cm
System protected for short circuit and reverse connection
Easy-to-install connectors
Working Temperature: -40 ° C to 80 ° C
(Standards: SAE J 1849 (American Automotive Engineers Association Standards
Quality System: CE, ISO 9001





MVSLight

Mehmet Akif Ersoy Mahallesi 287. Sokak
Golden Tower No: 7/9 Yenimahalle/ANKARA

sales@mvslight.com